

GRAY ELEMENTARY

10855 80TH Avenue, Delta BC V4C 1W4

Telephone: 604-594-2474 Fax: 604-594-1731



September 1, 2017

Dear Parents and Guardians:

Welcome back to a new school year! The staff would like to extend a special welcome to those who are new to the Gray community. We hope you all had a wonderful summer.

The first day of school is fast approaching; Tuesday, September 5th. Students in Grades 1 to 7 will attend class for a half day, 9:00-12:00. Kindergarten students attend from 9:15 a.m. to 10:00 a.m. **All Grade 1 to 7 students new to Gray this school year should report to the Gym.** All returning students should line up with their Grade group. Please see attached map. Larger maps will be posted on the front windows as well as at the Pod entrances.

It is very important for us to confirm our registration numbers as quickly as possible as we begin the school year. If your child will not be attending school on the first day, or week, please call the office to inform us. If your child is currently registered but will not be returning to Gray, please call to give us that information.

The students will be placed into temporary, alphabetical grade groups, and should expect to remain in these groups for the remainder of the week. Each group will have the opportunity to work with at least two teachers, allowing them to become familiar with staff members who will be working at their grade level. While students are anxious to find out whom their new teacher will be, and who will be their classmates, we must take the time to confirm our numbers and ensure that students are well placed. We will do all we can to complete that process as quickly and accurately as possible. **Please remember that parent input into class placement was provided last spring; requests will not be accommodated at this time.**

On Wednesday the 7th, the regular full day class schedule begins. The warning bell goes at 8:55 a.m. with classes beginning at 9:00 a.m. Lunch is 12:08-1:00 p.m. and dismissal is at 3:00 p.m. Signs have been posted around the building to indicate where each grade group will enter and leave the building on Tuesday. Please confirm with your child the door at which they will enter and leave the building for the remainder of the time until they are placed into their permanent classes.

Our first full newsletter of the year will be posted in the second week of school. We will continue sending out our newsletter in electronic form this year. Please ensure that we have your correct email address on file. Mrs. Turner, will have a limited number of printed copies available at the office for those families who do not have Internet access.

Sincerely,

Zena Ray
Principal

Patrick Klassen
Vice-Principal

First Day of School Grade Group Entrances

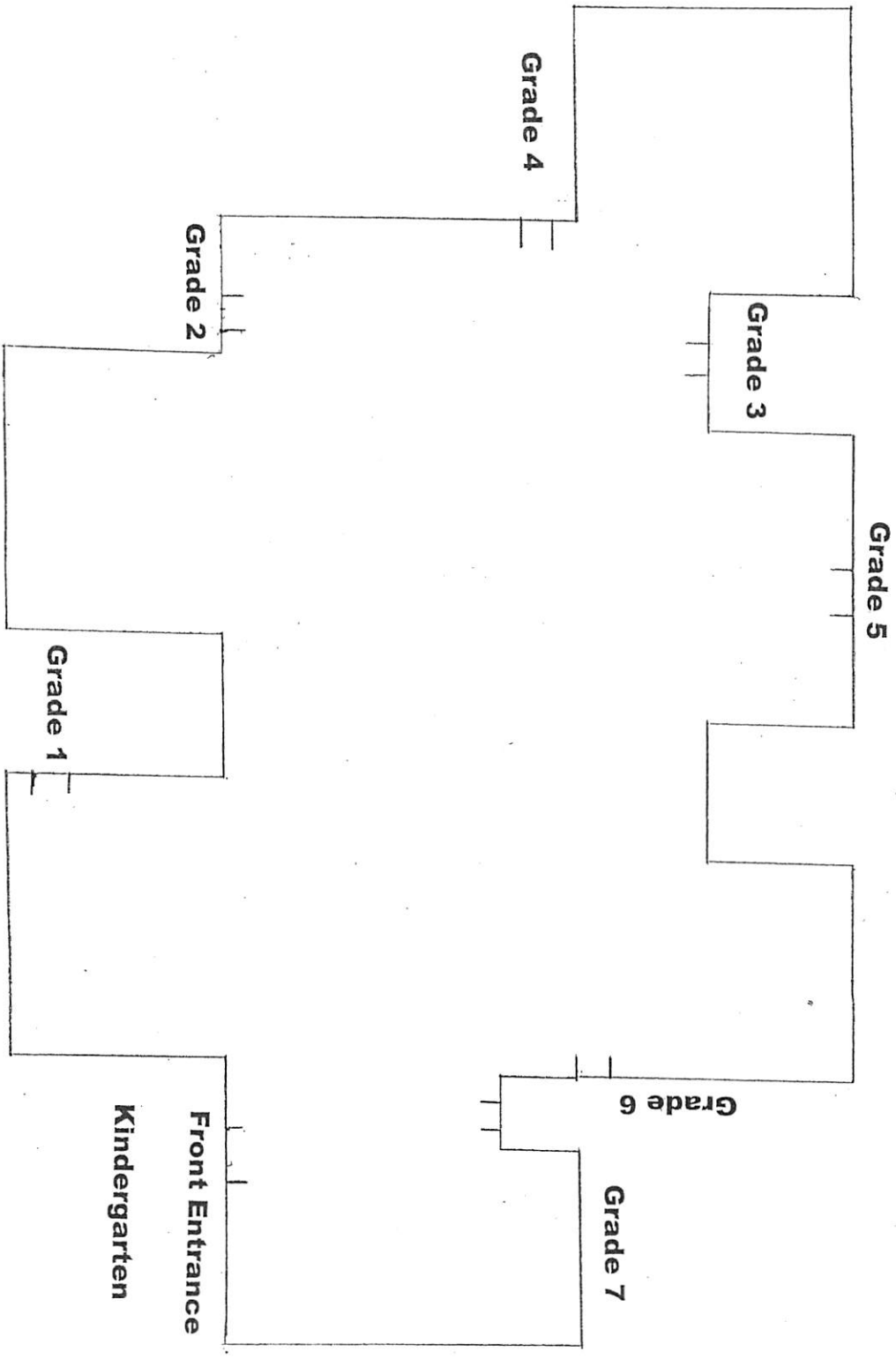

GRASS FIELD

BOTH AVE

PARKING LOT